



Oxley Dog Training Club Beginners Brochure

www.oxleydogtrainingclub.com.au

The Oxley Dog Training Club Inc. is a not for profit organisation, run totally by volunteers, specialising in Obedience Training and Socialisation Skills.

We are affiliated with Dogs NSW, and this year, we celebrate 52 years of training!

Our mission is to work in a dynamic relationship with our members to create simple effective methods in a friendly, positive club environment.

Our Trained Instructors, will help you train your dog to the level of Obedience you may desire.

Our Club also promotes Obedience, Agility and Rally O Trialling for those who are interested.

It is worth remembering, that most instructors put training their own dog aside, to help others.

We do however point out, that training your dog takes time and commitment, as Rome was not built in a day.

Though we do offer ongoing support, for all handlers who genuinely wish to achieve their training goals.

Cost of Membership

Single membership \$40 - Family membership \$40 - each weekly class \$10.00

Registration forms on website www.oxleydogtrainingclub.com.au or at the Oxley dog training club house

Oxley Dog Training Club (ODTC) is a non-smoking area

General Meetings are held after training on the first Sunday, bi-monthly. You are encouraged to attend, as we need member's support and input to make a better club.

We hope your dog and yourself, enjoy your membership, and please feel free to talk to any Committee Members, about any inquiry you may have.

Ground Rules:

1. All Children (younger than 12 years), and Junior handlers (12 to 16 years) are required to be under adult supervision at all times. This important rule is because of Insurance and Health & Safety concerns.
2. Members must be in class by the specified time. Instructors have the right to refuse instruction if you are late.
3. All dogs must be vetted by the Instructor before the commencement of training. No dogs will be allowed on the ground before being vetted.
4. Members without membership cards will not be permitted in class.
5. All dogs must be immunised against distemper, Hepatitis, Parvovirus and Kennel Cough. Current Vaccination Certificates must be presented when renewing membership.
6. No bitch in season is allowed to attend training
7. Dogs must be kept on a leash and under control at all times unless under the supervision of an instructor.
8. The handlers of dogs which foul the Club Grounds, must immediately clean up with the equipment provided or a plastic bag.
9. Classes using Club Jumps or other Agility Equipment will be responsible for returning it to the Equipment Room.
10. Vehicles are not allowed on Club Grounds without permission of the Executive or Committee Member
11. Observe all dogs with yellow ribbons and comply with the *Yellow Ribbon Signal (see next page)
12. Members must wear enclosed footwear, eg. joggers. Under no circumstances, are thongs and sandals permitted.
13. All members must keep their dogs, and themselves, a minimum of one metre from any tethered dog.
14. Grounds Access: Any Member in class 2 or above, is authorised to access the club grounds to exercise and train their dogs outside of normal Sunday Training. Members are totally responsible for their own actions, will also clean up after their dogs that have fouled the grounds with the provided receptacles, and close gates during and after use. Members are not permitted to exercise or train their dogs when the grounds are being used for a trial or event. The Committee reserves the right to deny, or revoke, authorised access to any member to the club grounds, outside of normal Sunday Training at their discretion.

15. ***The Yellow Ribbon Signal:** -

If you see a dog with a yellow ribbon or something yellow on the leash this is a dog who needs space. Please do not approach this dog or its people with your dog. They are indicating that their dog cannot be near other dogs. It means you must maintain at least a 3- lead length distance from that dog (approx. 12-15 feet or 4m). There are many reasons why a dog may need space:

- Maybe your dog has health issues and recovering from surgery or is in training.
- The dog maybe a rescue dog and is being rehabilitated (the world can be a very scary place for these dogs).
- Your dog may have had a bad experience with another dog or just not like the kind of friendly dogs who always want to say "Hi"
- Your dog may be timid or nervous around other dogs
- Your dog may have had a bad experience around other dogs with behaviour problems.

Whatever the issue may be, "My dog needs space, so kindly respect it"

Please ask a committee member if you require a yellow ribbon.

Important things to remember

1. If you have young children with you, be sure they only approach a strange dog with the owner's permission
2. No smoking is allowed on club grounds

Evacuation Plan:

Members are instructed, that in the extremely unlikely event of a fire in the Clubhouse, they are not to attempt to put out the fire. We are not trained firemen.

The correct procedure is to notify a Committee Member and anyone nearby (if possible), then with your dog, proceed to the Assembly Area, near the Swan Street Entrance, and wait. A Committee Member will wish to check that everybody is safe and accounted for.

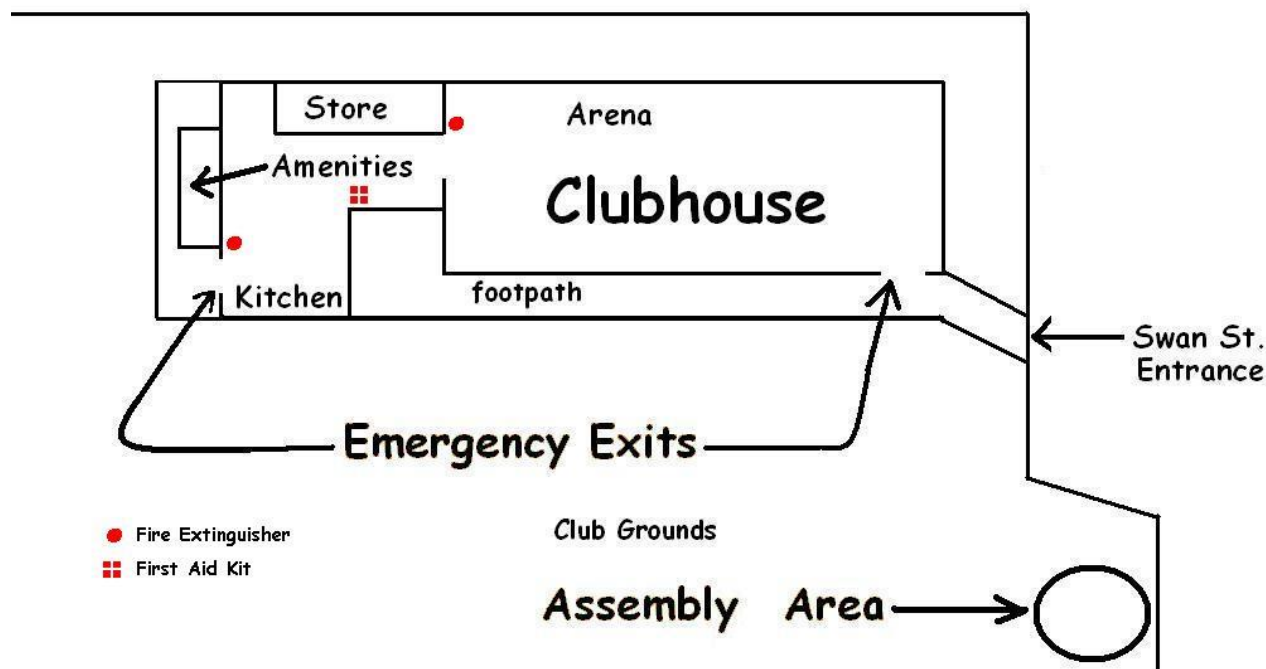

Phone Contact:- 6767 1321 or 6766 1081